

Backermex®

FOAM ROLL WITH PRE-CUT FOR SEALANT

COLOR: DARK GRAY
CELL STRUCTURE : CLOSED

R.VALUE: 1.30 - 1.60
OPERATING TEMPERATURE: -45 TO 159.8 °F

SPECIFICATIONS

Is a polyethylene foam-based closedcell expansion joint filler. Its design offers an alternative to the traditional asphalt-based fiber joints. It is highly flexible and compressible, which means it expands and compresses as joints move. This prevents humidity and other non-compressible materials from filtering and hampering the concrete's movement.

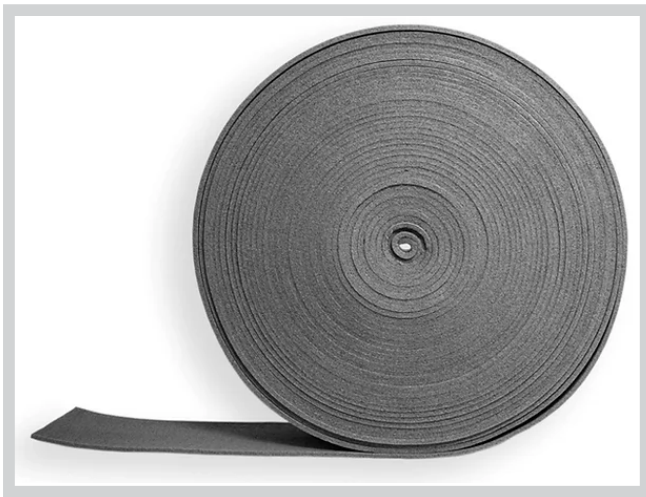

ROLLS SIZES 1/4"

1/4" INCH	1/4 " x 4" x 328 ft
1/4" INCH	1/4 " x 6" x 328 ft
1/4" INCH	1/4 " x 8" x 328 ft

ROLLS SIZES 1/2"

1/2" INCH	1/2 " x 4" x 196 ft
1/2" INCH	1/2 " x 6" x 196 ft
1/2" INCH	1/2 " x 8" x 196 ft

Backermex® meets all quality control standards and has a manufacturing warranty, however, since the implementation, design, and proofs are beyond our control, Backermex is not held accountable for the ultimate use that the product is given.

TECHNICAL DATA

Is chemically inert and resistant to oils, gasoline and other different solvents. It remains stable against UV radiation and weathering and it is not permeable nor absorbent. Additionally, sealing materials do not adhere to it.

COMPATIBILITY

Is completely compatible with polysulfide, butyl, acrylic, silicone, polyurethane and other cold temperature sealants.

USES

In expansion joints found in freeways, concrete streets, airport runways, curbs, and ditches. To separate all types of concrete floors or sidewalks in any construction site or structural element such as walls, columns, machine foundations, manholes, or cisterns.

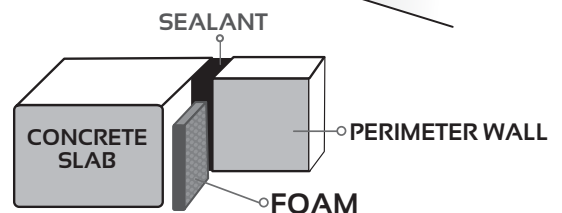
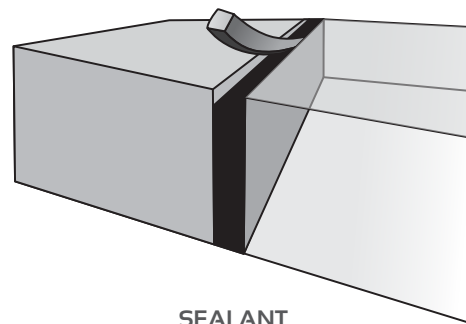
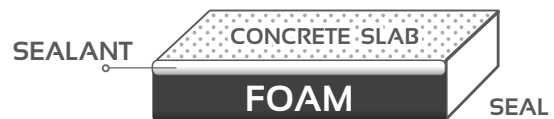

Backermex®

FOAM ROLL WITH PRE-CUT FOR SEALANT

COLOR: DARK GRAY
CELL STRUCTURE : CLOSED

R.VALUE: 1.30 - 1.60
OPERATING TEMPERATURE: -45 TO 159.8 °F

TECHNICAL DATA

TECHNICAL DATA	RESULTS	PROOF METHOD
Thickness (in)	0.5	
Color	GRAY	
Density (lb/ft ³)	1.5 - 1.7	ASTM D 3575-93
Cell structure	CLOSED	
Water absorption	< 0.1	ASTM D 3575-93 SUFFIX L
Flexibility +71°F -65 °F	ACCEPTABLE	PPP - C - 1752 D
Corrosiveness	NONE	Method 3005 FED STD101
Compression Set (PSI)	4.8	ASTM D 3575-93
	12.8	Suffix B
Tensile Strength (PSI)	48	ASTM D 3575-93
	32	Suffix T MD/CMD
Tear Resistance (lb/in)	14	ASTM D 3575-93
	18	Suffix G MD/CMD
Water Vapor Transmission Rate GM / 100 in/2/24 hr.	0.026	ASTM F-1249

Backermex® meets all quality control standards and has a manufacturing warranty, however, since the implementation, design, and proofs are beyond our control, Backermex is not held accountable for the ultimate use that the product is given.